

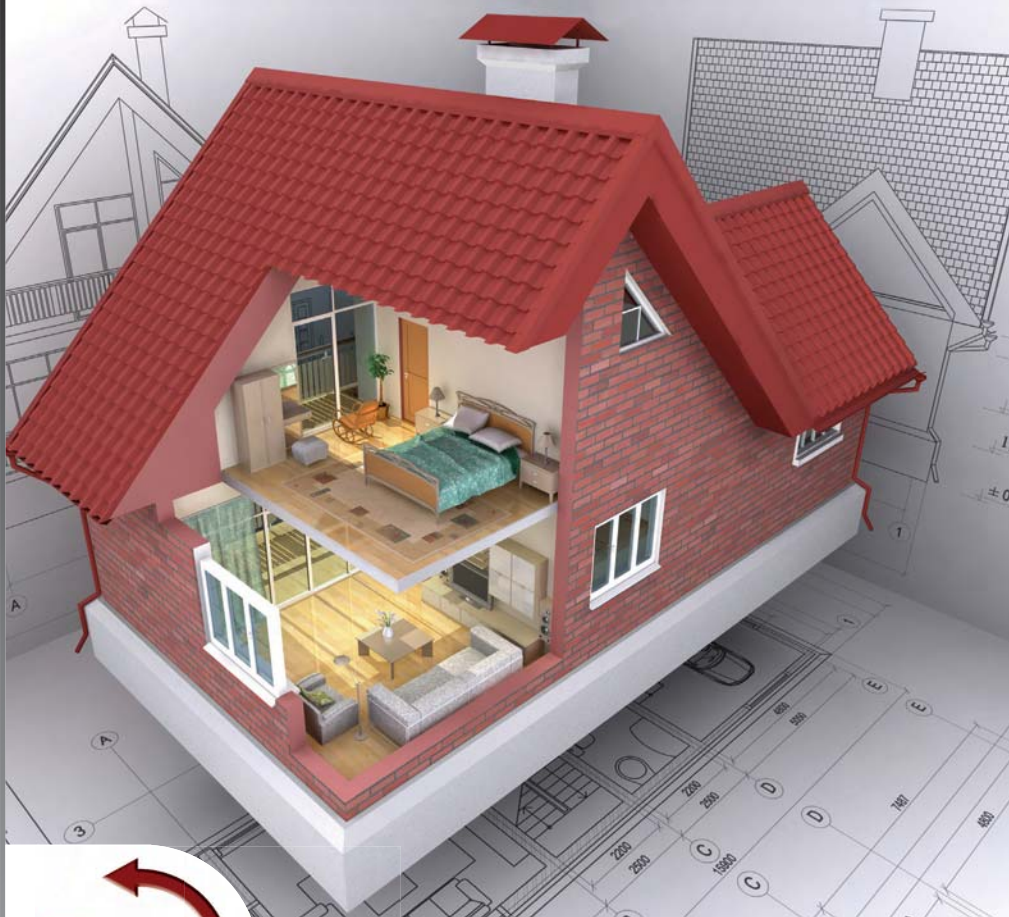

## ALL APPLIANCES BECOME INTELLIGENT... HOW ABOUT YOUR HOME?



Choosing for Velbus® means choosing for a future-proof system which provides comfort, safety and an improved energy management at a price which is just slightly higher than a classical wired installation.

### COMFORT



*Imagine coming home from a long day at work. With a single button press you turn on the heating, the blinds close, several lights turn on to create a cosy, intimate atmosphere. The wall outlets, which were switched off for safety reasons during your absence, are switched on again...*

### SAFETY



*A sudden noise wakes you up in the middle of the night. Press your bedside button and your home comes alive. All lights are turned on and all blinds open. The garden lighting starts flashing to attract attention...*

### SAVING ENERGY



*Bedtime. Again, you press a single button. All lighting is turned off and nightlights start to glow. The garden remains lit for another hour. Wall outlets are turned off for safety reasons and to reduce electro-smog. The heating switches to night mode.*

VIRTUAL DEMO ON [WWW.VELBUS.EU](http://WWW.VELBUS.EU)



## THE VELBUS®-SYSTEM

Choosing for Velbus® means choosing for an up-to-date electrical installation. Contrary to a classical installation with its limitations, the Velbus® system offers you a solution for every problem. The modular character (no use of a central unit) and the bus structure (4 conductors) keep down the installation costs. This professional domotics system is thus within anybody's reach. You really do not need a house with restrictions; just use the Velbus® domotics system and create any atmosphere that matches your way of life. By configuring the Velbus® through your PC, you can even back-up all modules individually.



FEEDBACK INDICATION



WEEKLY PROGRAMS



CLOCK  
SYNCHRONISATION



CENTRAL HEATING  
PUMP PROTECTION



STAIRCASE LIGHTING TIMER



SLOWLY OFF DIMMER



REMOTE CONTROL



ALARM FUNCTIONS



TIMERS



DIFFERENTIAL TEMPERATURE

## WHY VELBUS®?

- Very attractive price
- User-friendly installation and configuration, with or without PC
- Always expandable system
- Very easy installation
- Non-critical bus wiring: star/loop/tree or a combination of these
- Extremely reliable system thanks to the use of modules

# CONFIGURATION EXAMPLE

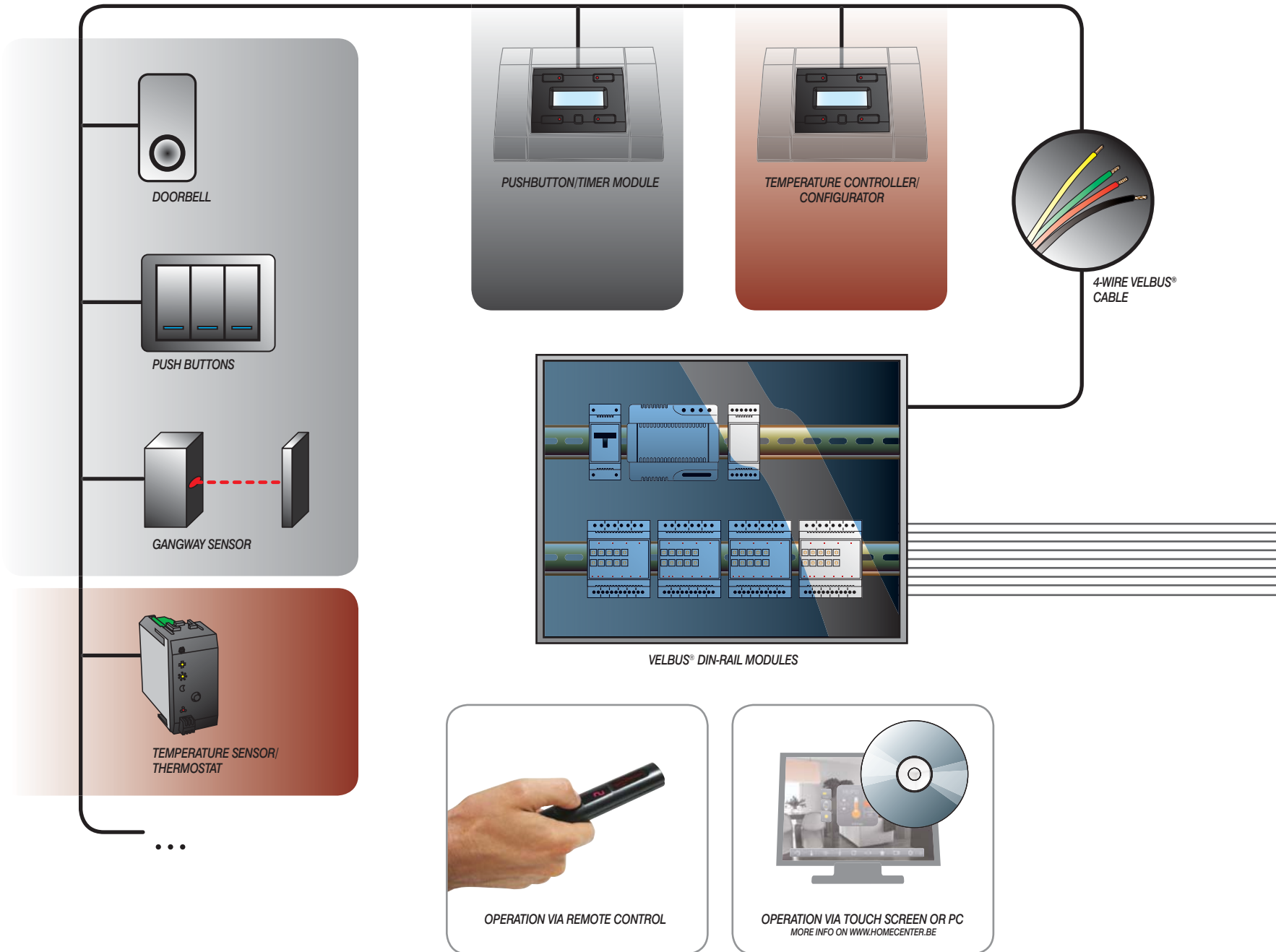

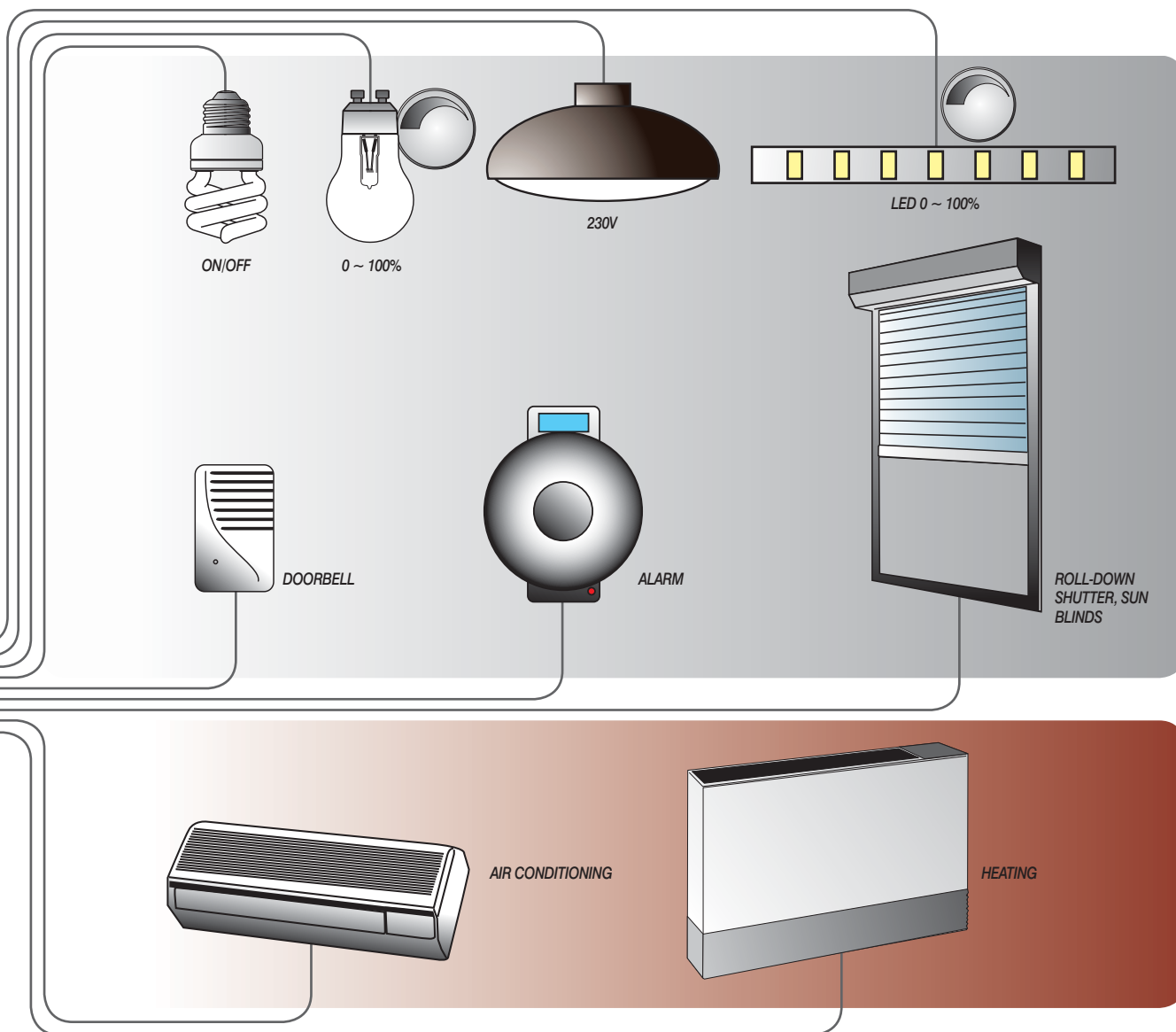

## WITH VELBUS® YOU CAN:

- Assign names to push buttons
- Open the roll-down shutters automatically at a specific point in time
- With one push on a button switch on all lighting and close the roll-down shutters
- With one push on a button switch off all lighting and mains outlets and open the roll-down shutters
- Check the status of all lighting points via the LCD panel
- Dim the background lighting of the LCD panel at a predefined point in time
- Control operation via the optional remote control
- Dim multiple lighting outputs at once to create different atmospheres
- Set the heating of the bathroom to comfort mode using the remote control
- Use a motion detector to switch on the light in a passageway for 5 minutes
- Slowly increase bedroom lighting in the morning in a 30' time span
- Set the heating to night mode for a couple of days and switch to comfort mode automatically after returning from holiday
- ...

# MODULES



## PUSHBUTTON/TIMER MODULE

VMB4PD

With this LCD panel you can control everything on the Velbus®. Also via the built-in weekly program or by using the remote control.

Some features:

- built-in IR receiver
- weekly program (20 steps)
- 2 pages with 4 controls each
- buttons with feedback LED
- change labels via the module or PC
- backlight with day cycle
- fits in a BTicino® frame
- ...

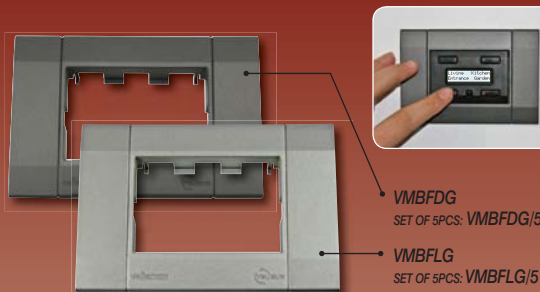

VMBFDG  
SET OF 5PCS: VMBFDG/5

VMBFLG  
SET OF 5PCS: VMBFLG/5

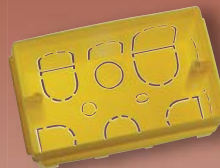

VMBBOX



VMB1DS

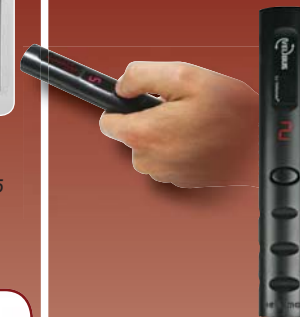

## REMOTE CONTROL

VMB1RTS

Works with the LCD-module VMB4PD



## 8-CHANNEL PUSHBUTTON MODULE

VMB8PB

To connect any type of pushbutton to the Velbus®. Up to 8 pushbuttons can be linked.



## TRANSFORMER

VMBTR1

Transformer 50 VA



## POWER SUPPLY MODULE

VMB3PS

- works together with transformer VMBTR1
- 3 X 12V 1A



## 1-CHANNEL RELAY MODULE

VMB1RY

- 1 NO/NC contact
- modes: momentary, start/stop, staircase lighting timer, timer at release, delayed on/off...



## DIMMER MODULE

VMB1DM

- 300W dimmer
- modes: momentary, start/stop, staircase lighting timer, delayed on/off, multi-position, memory function...

## 4-CHANNEL RELAY MODULE

VMB4RY

- 4 NO contacts
- same modes as VMB1RY

## LED DIMMER MODULE

VMB1LED

- LED dimmer 12/24V 5A
- same modes as VMB1DM

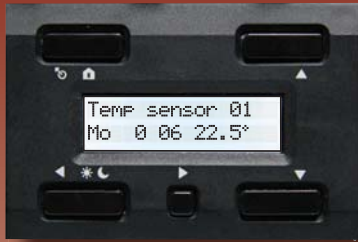

### TEMPERATURE SENSOR/THERMOSTAT VMB1TS

- anti-freeze, night, day, comfort setting
- steers relay contacts that will drive the heating/air-conditioning
- works in combination with the temperature controller/configurator (VMB1TC) and/or VelbusLink PC Interface'

### TEMPERATURE CONTROLLER/CONFIGURATOR VMB1TC

- supports from 1 up to 32 temperature sensors (VMB1TS)
- can group sensors into zones
- built-in weekly program

### BLIND COVER PLATE VMBFB1

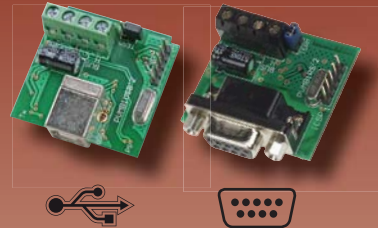
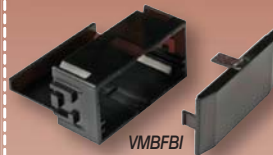

### PC INTERFACE VMB1USB / VMB1RS

Control and configuration via PC.



SOFTWARE "VELBUSLINK" FREE DOWNLOAD AND USE



### 1-CHANNEL BLIND CONTROL MODULE VMB1BL

- 1 channel
- controls blinds, awnings ...
- switches off after maximum 2 minutes

### 2-CHANNEL BLIND CONTROL MODULE VMB2BL

- 2 channels
- same features as VMB1BL



### 6-CHANNEL INPUT MODULE VMB6IN

- 6 channels
- can be used for connecting contacts and sensors to the Velbus®



### RS232/USB MODULE VMBRSUSB

- DIN rail mounting
- control and configuration of the Velbus®

TO BE EXPECTED

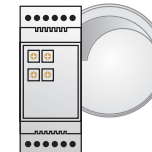

VMB4DC  
0-10V DIMMER OUTPUT MODULE



VMBMPD  
MULTI-PAGE CONTROL MODULE

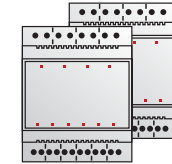

VMB4RYLD + VMB4RYNO  
4 CHANNEL RELAY MODULES,  
PC CONFIGURABLE

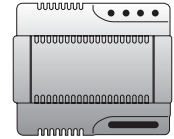

VMB5MPS  
SWITCHING MODE POWER  
SUPPLY 5A/12-14VDC

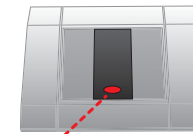

VMB8IR  
IR RECEIVER



VMBHC  
TOUCH SCREEN/PC SOFTWARE  
© STJUNEN SOLUTIONS

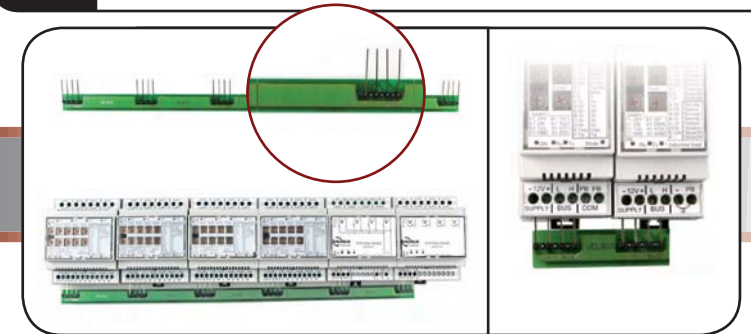

### INTERCONNECTION RAIL

6X4M MODULES: VMBRAIL / 2X2M MODULES: VMBRAIL2

This interconnection rail is perfectly suitable to interconnect your Velbus® modules. Saves time and work when connecting your system!



Our building is equipped with a Velbus®-configuration that consists of more than 150 modules and 38 temperature sensors.

For almost 40 years Velleman has been a major supplier of electronics. It has its own research and development department. More than 120 staff members, a warehouse of 35.000m<sup>3</sup> and offices all over the world make Velleman an important international player on the electronics market.

**Information:**

Velleman NV  
Legen Heirweg 33  
9890 Gavere  
Belgium  
☎ +32 9 384 36 11  
☎ +32 9 384 67 02  
info@velbus.be  
www.velbus.eu  
www.velleman.eu

COPYRIGHT VELLEMAN®  
MISPRINTING AND MODIFICATIONS IN  
IMAGES AND TEXT RESERVED. BTICINO® IS A  
REGISTERED TRADEMARK OF BTICINO S.P.A.

FOL/VELBUS03EN

